

Directional Coupler

P/N: ZSDC-10670-10K

1. Electrical Specifications

Frequency Range	1– 67GHz
Nominal Coupling	10±3.5dB max
Frequency Sensitivity	±3.0dB max
Insertion Loss	3.8dB max (Excl Coupling Power)
VSWR (mainline)	1.9 max
VSWR (secondline)	1.9 max
Directivity	8dB min
Power Handling	50W
Impedance	50ohm
RF Connectors	1.85-Female
Operating Temperature	-45°C ~ +85°C
Storage Temperature	-55°C ~ +85°C

2. Mechanical Specification (for reference)

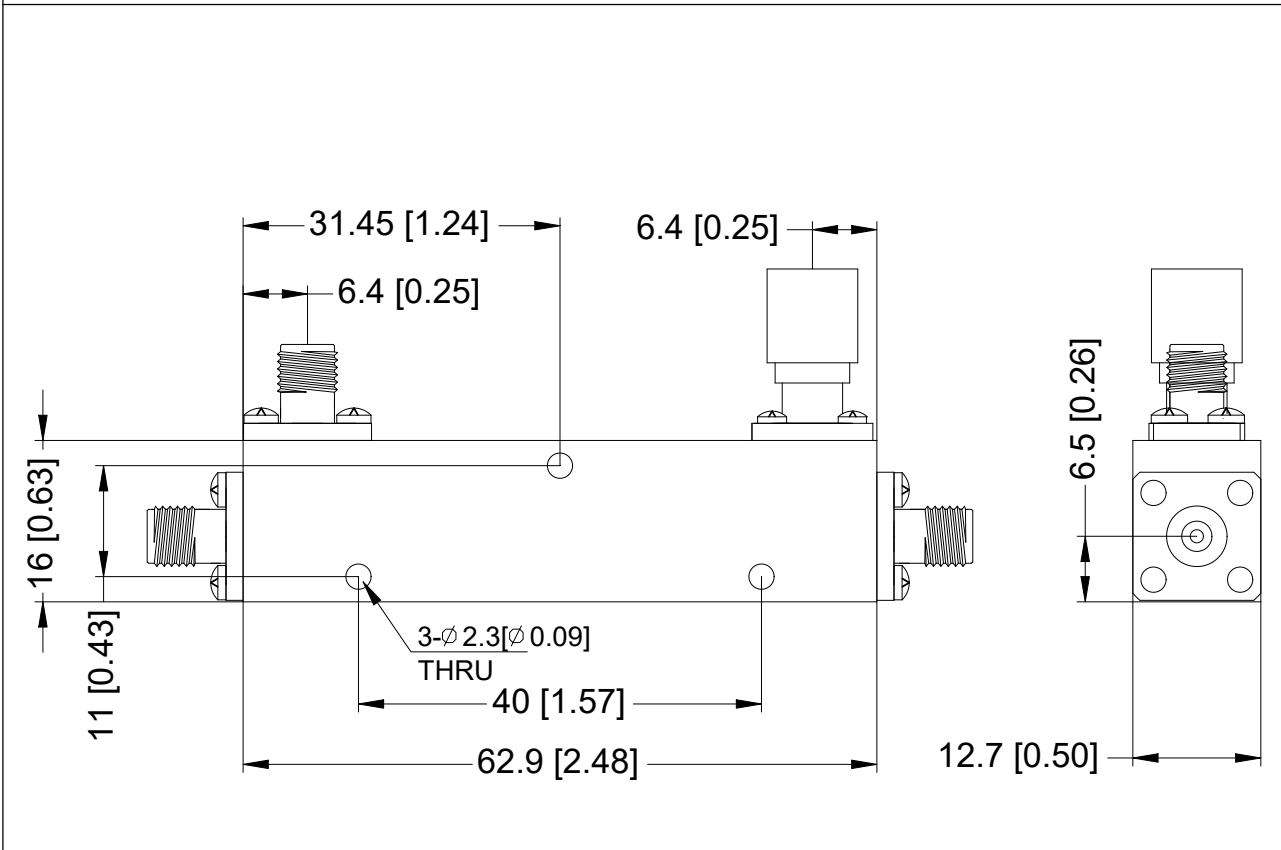

Typical Test Curve:

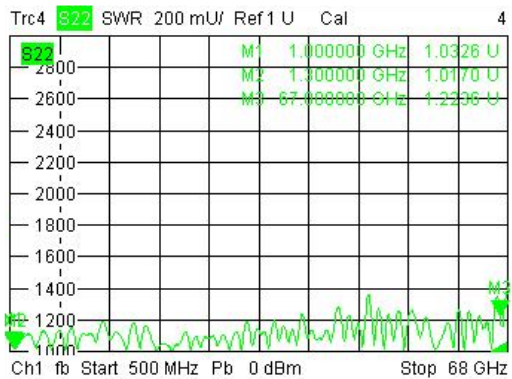
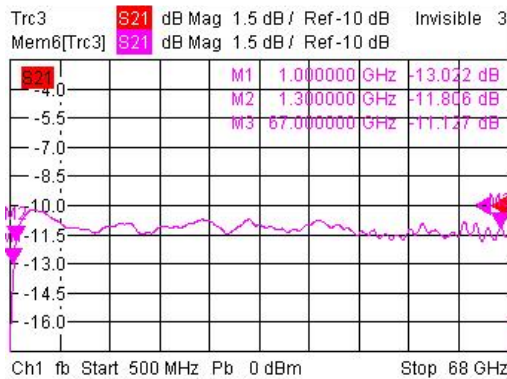
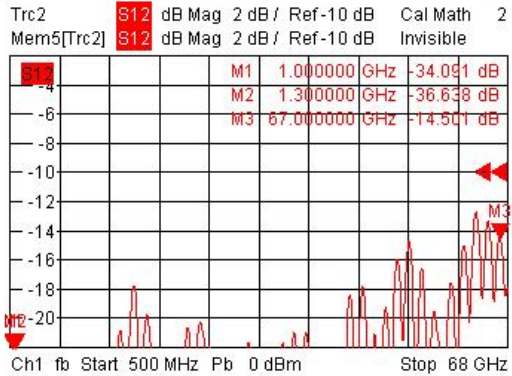
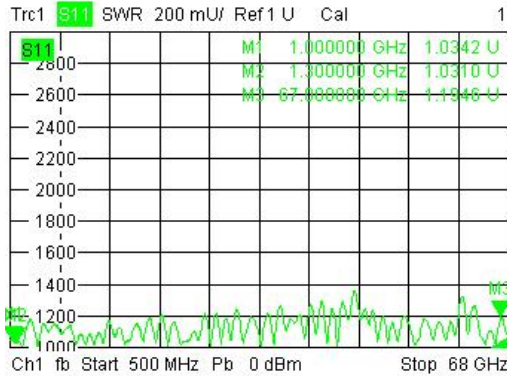

Trc2 **S12** dB Mag 2 dB / Ref -10 dB Cal Math 2 (Max)
Mem5[Trc2] **S12** dB Mag 2 dB / Ref -10 dB Invisible

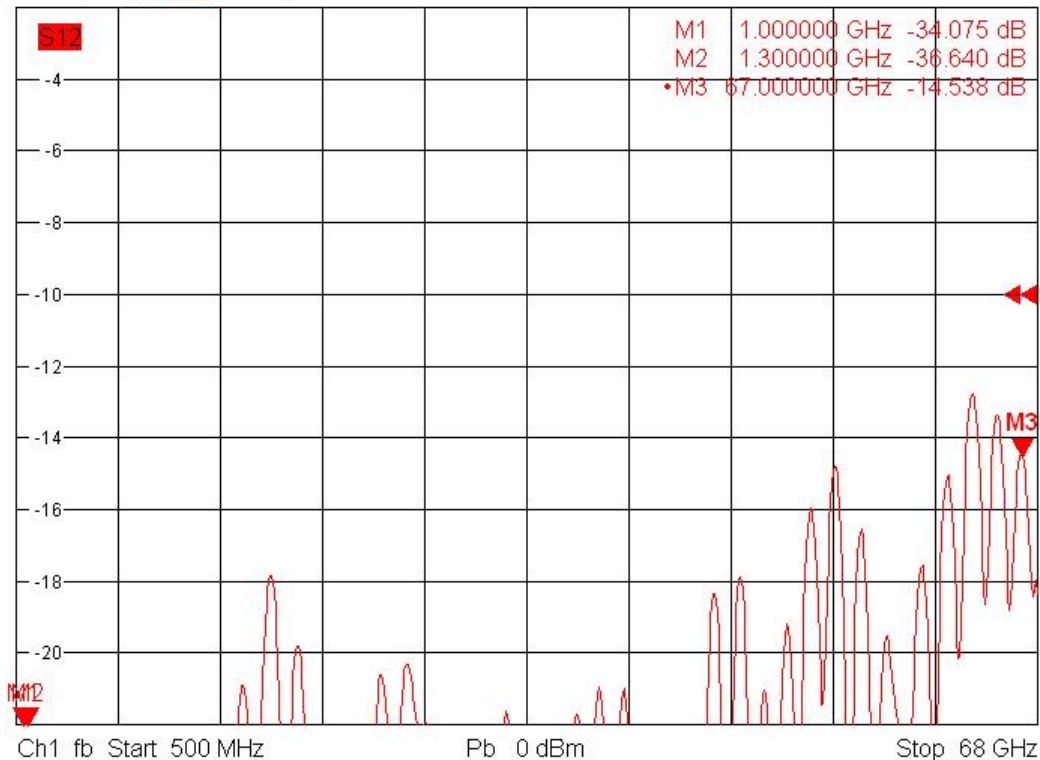

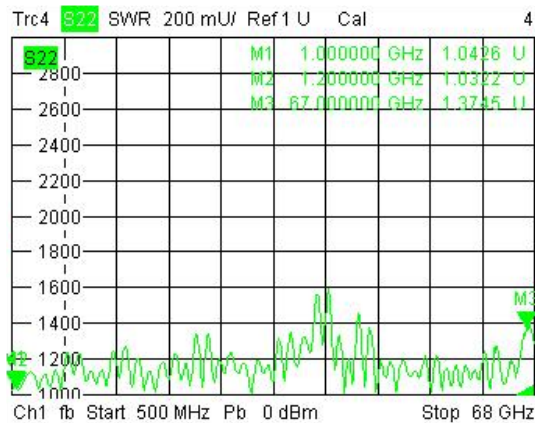
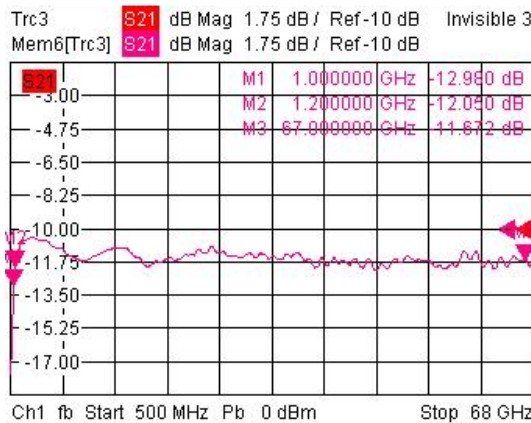
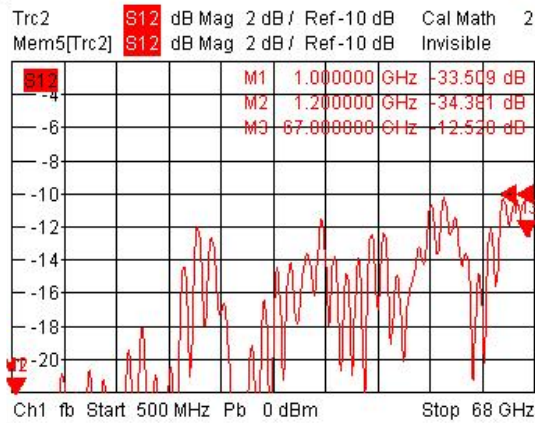
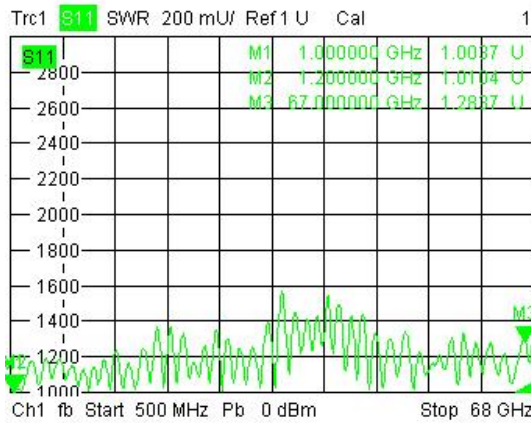

Trc2 **S12** dB Mag 2 dB / Ref-10 dB Cal Math 2 (Max)
Mem5[Trc2] **S12** dB Mag 2 dB / Ref-10 dB Invisible

